

# SUPER CAPACITOR MODULE

## SM-5R5-405UL

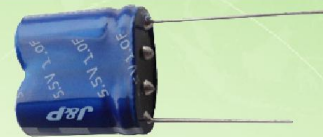

### 1. SCOPE

This document describes the Product Specification of Super capacitor and Super capacitor module supplied by J & P

### 2. Type and model

2.1 Type: Cylinder type Super capacitor module

2.2 Model: SM-5R5-405 UL

### 3. Specifications

No.	Items	Specification/Condition
01	Product model	SM-5R5-405 UL
02	Rate discharge capacitance (F) (25°C, $\Delta V=1.5V-1.25V$ $I=0.1A$ )	4.0
03	Capacitance tolerance	- 10%~+20%
04	Operating temperature range	-25°C~+70°C
05	Rated Voltage $U_0$ (V)	5.5
06	ESR (m $\Omega$ ,1KHz, 25°C), Max	200
07	Dimension (mm LxWxH)	26x13x23
08	Tab-lead distance(mm p)	18±0.5
09	Tab-lead diameter(mm dXb)	0.6
10	Cycle life expectancy	After 100,000 times of cycles between $U_0$ 1/2 $U_0$ at RT,   $\Delta C/C$   ≤30%, ESR≤4 times of specified ESR (25°C)

### 4. Environmental Characteristics

No.	Items	Specification/Condition
01	Temperature characteristics	$\Delta C/C$   ≤30%, ESR ≤ specified ESR(25°C) at +70°C   $\Delta C/C$   ≤50%, ESR ≤ 4 times of specified ESR (25°C) at -25°C
02	High temperature load	$\Delta C/C$   ≤30%, ESR ≤ 4 times of specified ESR (25°C) at +70+/-2°C/1000hrs/rated voltage
03	High temperature storage	$\Delta C/C$   ≤30% , ESR ≤ 2 times of specified ESR ( 25°C ) at +70+/-2°C/1000hrs/standby after fully charge
04	Humidity Resistance	+40°C+/-2, 90--95%RH, 240h ,   $\Delta C/C$   ≤30%, IL ≤ 2 times of specified leakage current, ESR ≤ 4 times of specified ESR (25°C)

### 5 Part NO.

S	□	□□□	□□□	□	□				
Super Capacitor	Series	Rated Voltage		Capacitance	Tolerance	Leads Type			
Code	Series	Code	Voltage	Code	Value (F)	Code	TOL.	Code	Leads
P	Power	2R5	2.5V	104	01	J	±5%	H	Coin H
E	Energy	2R7	2.7V	224	0.22	K	±10%	V	Coin V
LR	Low ESR	3R3	3.3V	334	0.33	M	±20%	C	Coin C
M	Module	5R0	5.0V	474	0.47	U	-10%~20%	L	Radial leads
		5R5	5.5V	105	1.0	V	10%~30%	S	Screw terminal
		6R3	6.3V	155	1.5	Z	-20%~80%		
		12	12V	205	2.0				
		24	24V	335	3.3				
		36	36V	475	4.7				
				805	8.0				
				106	10				
				206	20				
				306	30				
				506	50				
				107	100				
				158	1500				
				308	3000				

## 6. Product Dimension

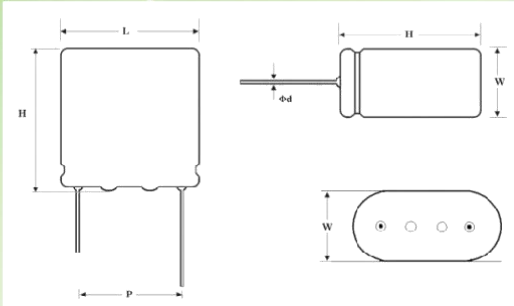

Size (mm): LxWxH±2	26X13X23
Lead Space P (mm)	18±0.5
lead diameter Φd(mm)	0.6±0.05

## 7. Test Result

(1) Temperature characteristics

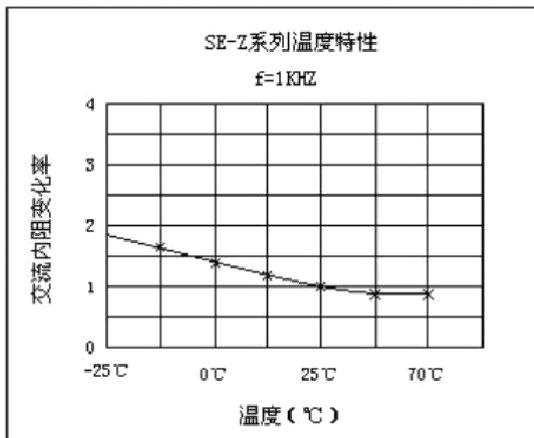

(2) Life characteristics

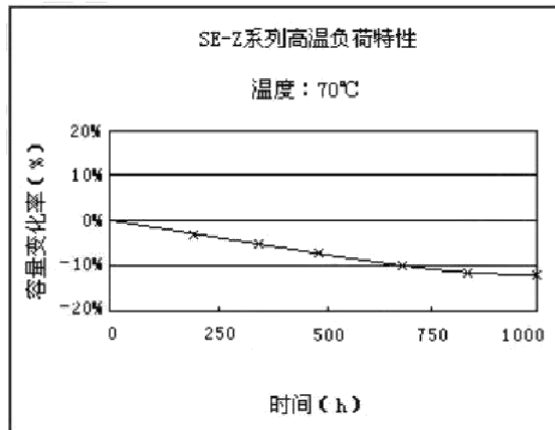
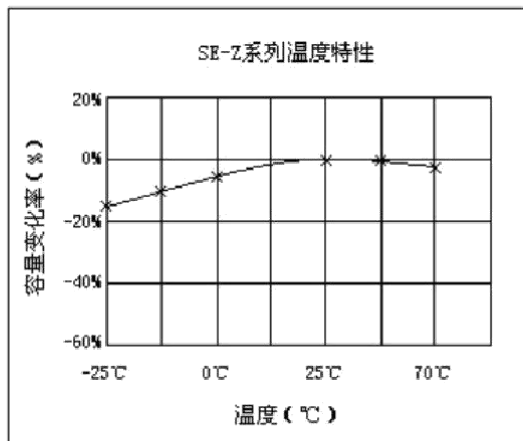
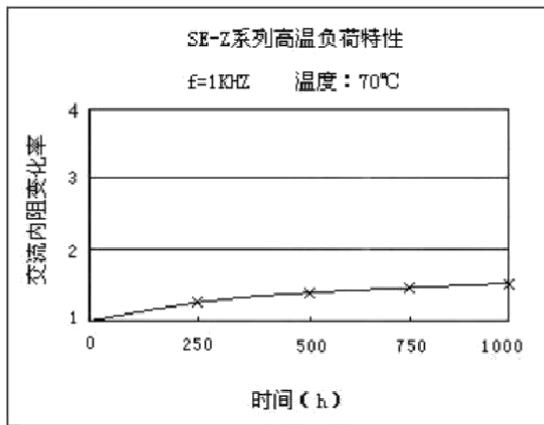

(3) 漏电流特性:

